

700 lf of half street improvements adjacent to the school site for the North half of Broadway Road. the improvement drawings for the adjacent way improvements includes water, storm drain, concrete, paving, dry utilities, signage and striping, street lights landscaping, irrigation and inerts.

Littleton Elementary District New Elementary School at Alamar Development - 23 degrees southwest of due west center of Broadway Road and Avondale Blvd intersection – Adjacent Ways Submittal

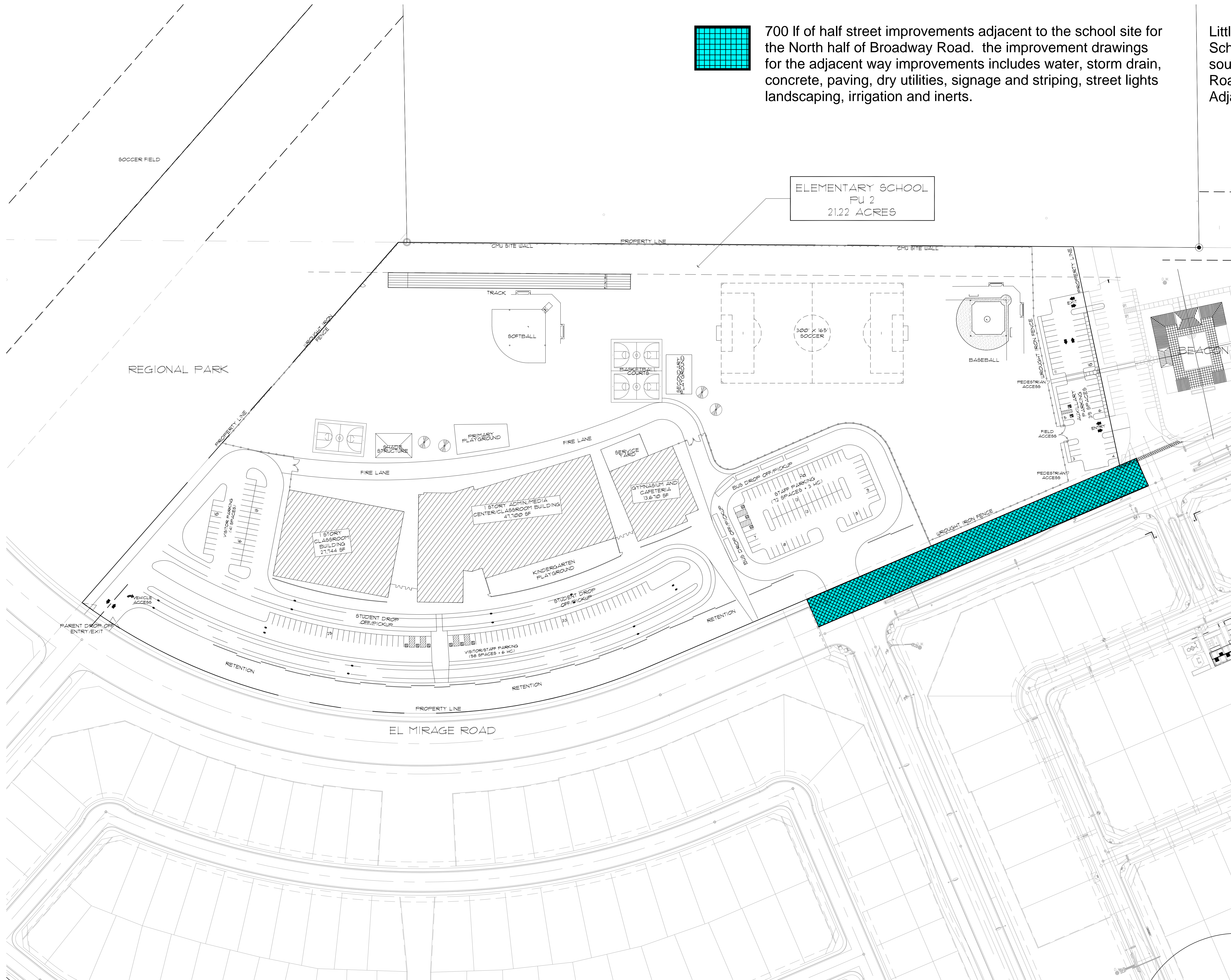

SP-10

ALAMAR

ELEMENTARY SCHOOL PLAN
EL MIRAGE ROAD
AVONDALE, AZ

FEASIBILITY STUDY
1" = 70'-0"



adm group, inc.
2100 west 15th street
tempe, arizona 85281-6942
tel: 480.285.3800
fax: 480.285.3801

SEPTEMBER 24, 2019
7010-101

CONCEPTUAL SITE PLAN-OPTION 10A